

# HOTEL ROOM OFFER

## Product guide 2014



FROM ACCESS CONTROL  
TO GUEST ROOM  
**SOLUTIONS**



> 501  
520

## HOTEL ROOM OFFER

### A complete range that meets all kinds of requirements

BTicino offers a specific system solution for each requirement. Designed to guarantee the best welcoming and control service without overlooking the environment, BTicino hotel offer brings together two aspects: the supervision, managed by Hotel personnel, and the management of the room by the Customer. Two separate worlds, that are however in constant communication.



## Contents

4-5	Introduction	Livinglight modularity and customization	4
6-7	General features	A complete solution for hotels	6
8-11	Livinglight	Livinglight hotel solutions Coverplates	8 11
12-13	Feeling at home	Guestroom Example	12
14-15	SCS solution	SCS room solution: main system components	14



# LIVINGLIGHT

Countless finishes in versions:  
Light, Living, Air.



## THE BEST PLATFORM

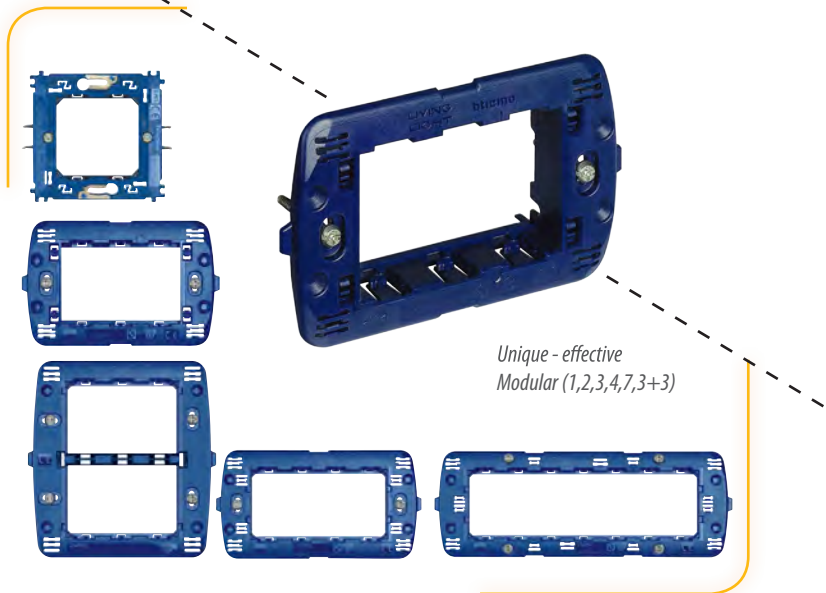

"More than 300 Functionalities"



4 MODULES







### INSIDE THE ROOM

- Access control
- Climate control (heating and cooling)
- Lighting control
- Automation management
- Wired and Wi-Fi network management
- Traditional devices (energy sockets, etc...)

**From access control to home automation, BTicino offers all the technological solutions for the hotel sector**



### IN COMMON AREAS FOR CUSTOMERS

- CCTV
- Climate control (heating and cooling)
- Lighting control
- Automation management
- Sound system
- Wi-Fi data network management
- Emergency lighting
- Traditional devices (energy sockets, etc...)

## Specific products and systems for the establishment

TECHNICAL ROOMS, PUBLIC AREAS,  
GUESTROOMS: A COMPREHENSIVE  
OFFER FOR THE ENTIRE BUILDING

# A COMPLETE SOLUTION FOR HOTELS

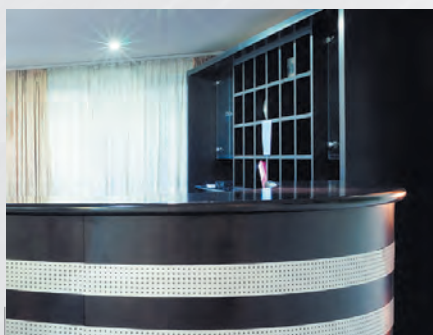

### AT THE RECEPTION

#### THE SOFTWARE PROVIDES:

- Supervision and management of all the systems and functions installed in the hotel
- Control and management of the functions inside the rooms and the common areas
- Management of the room status (free, occupied, customer present)
- Access control management: programming of keycards and saving of accesses
- Management of bookings, also using specific software (PMS)



### REST OF THE BUILDING

- Energy transformation
- Energy distribution
- Service continuity (UPS)
- Energy management (measurement)
- Climate control (heating and cooling)
- CCTV
- Access control
- Lighting control
- Automation management



# LIVINGLIGHT

## hotel solutions



**OUTSIDE THE ROOM:**  
"DO NOT DISTURB - MAKE UP ROOM" INDICATOR,  
DOOR BELL



**INSIDE THE ROOM:**  
SUPPLY BADGE POCKET, "DO NOT DISTURB - MAKE UP ROOM" SELECTOR

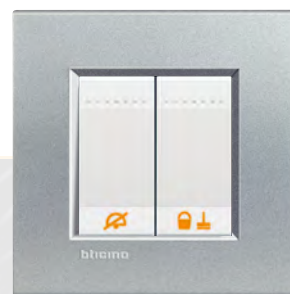

### IMMEDIATELY AT EASE

The presence of a badge holder socket invites the guest to immediately interact with the room.



INTERNATIONAL SOCKET



DUPLEX SOCKET



TV/SAT/RJ45

### A SOCKET FOR ANY STANDARD

Multistandard sockets guarantee peace of mind to customers of any nationality.

The extensive modularity allows for different combinations: full customization of size and color.





ELECTRONIC AND DIGITAL THERMOSTAT



NEW BUS-SCS THERMOSTAT

## THE RIGHT TEMPERATURE AT ANY TIME

Electronic and timer thermostats, now paired with a brand new product specifically designed for hotel rooms, managing both room temperature and fan speed.



SHAVER SOCKET



EMERGENCY LIGHT



STEP MARKER

## EXTRA ATTENTION TO SAFETY

Step marker lamps for the night, emergency lights, alarm pull cords and protected razor sockets to ensure maximum safety at all times.



"DO NOT DISTURB - MAKE UP ROOM" INDICATOR, DOOR BELL AND BADGE READER



DIGITAL THERMOSTAT



8 KEYS CONTROL (CUSTOMIZABLE)

## THE RIGHT ATMOSPHERE, IN ONE MOVE

Thanks to the new MYHOME devices installed at the side of the bed is possible to recreate the desired atmosphere, adjusting lights, temperature, curtains.

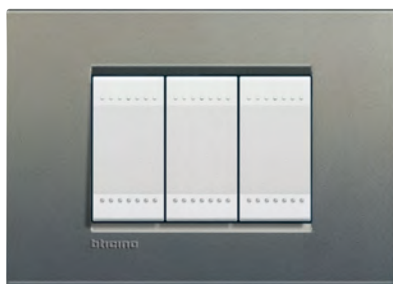

Avenue - AE

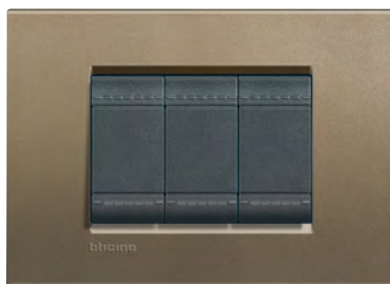

Square - SQ

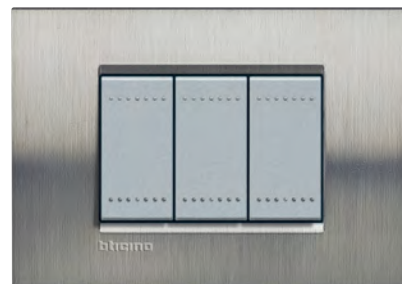

Brushed steel - ACS



Anthracite - AR



White - BI

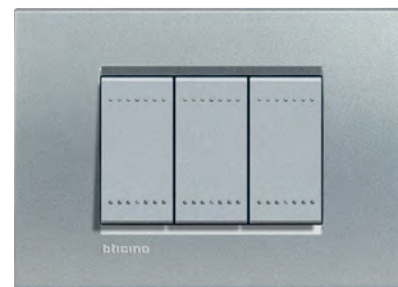

Tech - TE



Light aluminium - AL



True gold - OR



Light titanium - TC



Bright chrome - CR



Oxidized bronze - BO



Dark steel - AC



The BTicino offer for the rooms, and in wider terms for the whole hotel establishment, includes many more devices that are normally also used for other applications.

**Request the Livinglight catalogue and check the whole range of coverplates and functions**



# FEELING AT HOME

A complete offer for a state of the art electric system in the hotel room

Maximum attention to customer requirements in terms of:

- available services
- comfort
- simple interaction with products and functions

## CUSTOMIZABLE SWITCHES

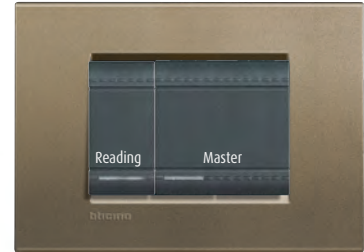
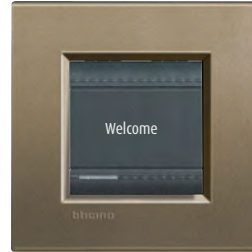

## ACCESS CONTROL

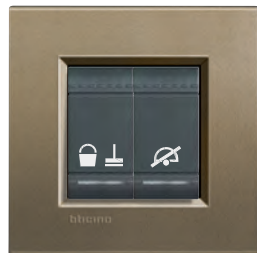

OUTSIDE THE ROOM:  
"do not disturb - make up room" indicator,  
door bell

INSIDE THE ROOM:  
supply badge pocket,  
"do not disturb-make up room" selector

## BEDSIDE PANEL



To easily control curtains, lighting, temperature, ...

## EMERGENCY LIGHT



In case of blackout it allows up to 3 hours of light:  
the security of always having a point of reference

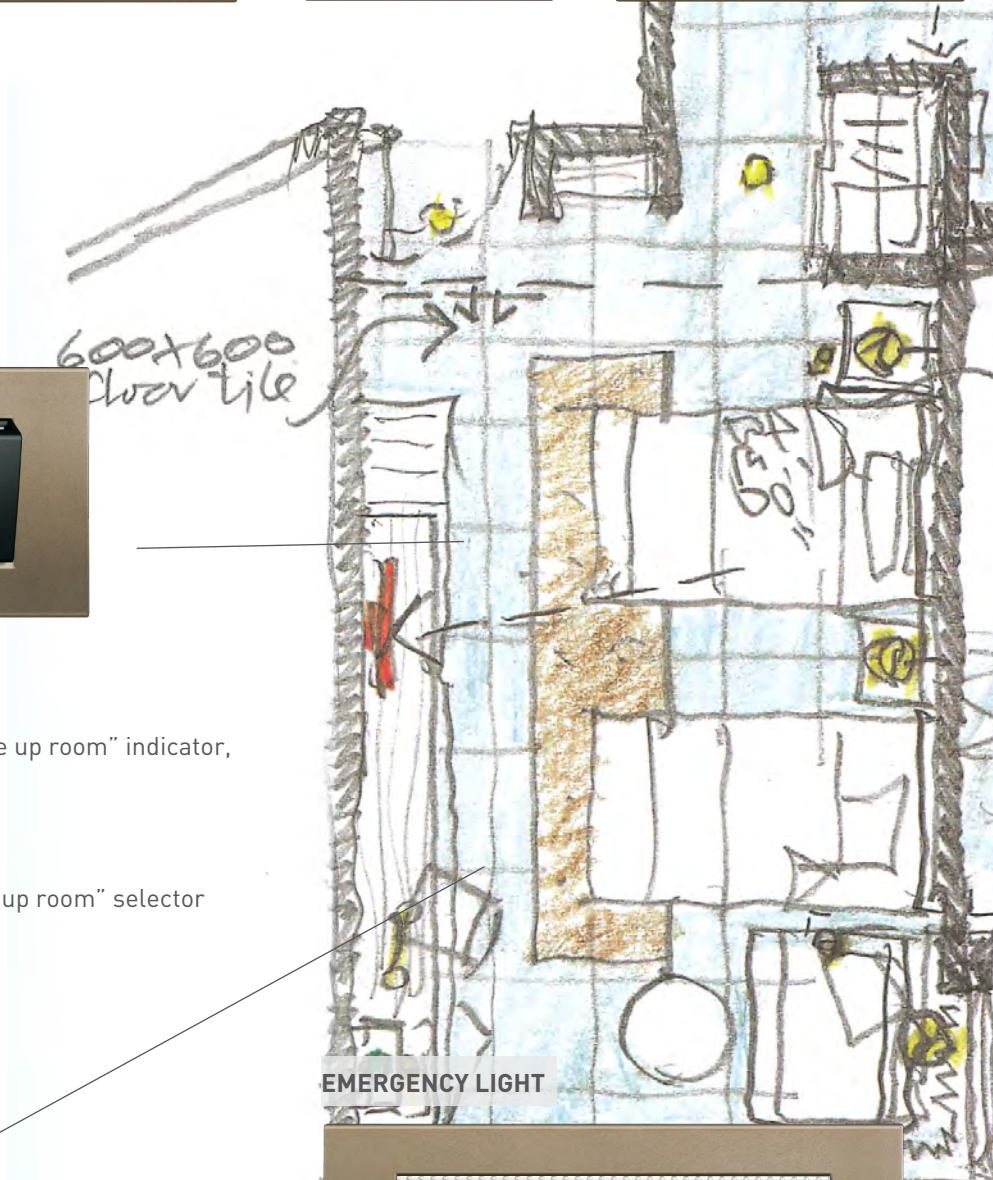



**MULTIMEDIA**



**TV/SAT SOCKETS**



**MINIBAR**



**WORKING TABLE**



**LEFT/RIGHT BEDSIDE**

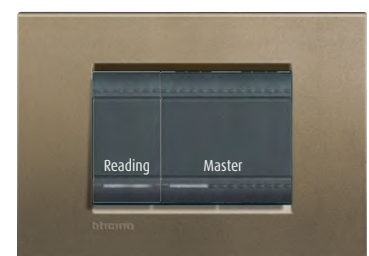

**BATHROOM**



Protected shaver sockets, multistandard sockets, and step marker lamps for conveniently reaching the bathroom without having to turn on any bedroom light

## THE MAIN SYSTEM COMPONENTS

# THE **bticino** SCS SOLUTION



## In the corridor - outside the door



### KEYCARD READER

RFID technology, with DND (do not disturb) & MUR (make up the room) notifications, and bell pushbutton



### KEYCARD

RFID technology, credit card format, for access to the rooms



### DND - MUR NOTIFICATIONS

DND (do not disturb), MUR (make up the room) and bell pushbutton

## Inside the room



### DND AND MUR CONTROL

DND (do not disturb)  
MUR (make up the room)



### KEY CARD SWITCH

with possibility of RFID technology recognition, for the activation of the functions inside the room



### DIGITAL THERMOSTAT

to set and adjust the temperature inside the room.



### 8 KEY CONTROL

to recall the scenarios (lighting, automation, climate, ...) inside the room.





## At the switchboard



### SCENARIO MODULE IP

manages and saves all the scenarios (max. 50) of the room or zone, and acts as interface with the rest of the system and the functions of the Hotel. It connects to the rest of the hotel using the Ethernet network (RJ45).



### ACTUATORS

for the management of the temperature control system. In addition to those included in the MyHOME offer, 3 more new actuators are available.

## At the reception



### SUPERVISION SOFTWARE

to control the status of the rooms with the corresponding notifications, and manage the available functions. It also perform functions connected with the programming of the keycards.

2 types of software available:

- Management of up to 20 rooms or common areas
- Management of over 20 rooms or common areas

### KEYCARD PROGRAMMER

to connect to the reception PC through USB connection





## BTicino Concept Store | Bangkok



TRAINING CENTER | BANGKOK



PHUKET SHOWROOM

VISIT OUR SHOWROOMS Monday to Friday (10 a.m. - 5 p.m.)

### BTicino (Thailand) Limited

#### Bangkok | Office

10th F Ploenchit Center,  
2 Sukhumvit Road,  
Klongtoey, Bangkok 10110  
Tel. +66 (0) 2 656 9162 - 7  
Fax. +66 (0) 2 656 9197

#### Phuket

Unit No. 12-13 The Court Yard  
90/5 Moo 2, Chaofa Road West  
Vichit, Muang, Phuket 83000  
Tel. +66 (0) 7 626 4477  
Fax. +66 (0) 7 616 4494

Bangkok | Concept Store  
G Floor Ploenchit Center

Bangkok | Training Center  
12th Floor Ploenchit Center



**bticino**

A Group Brand | **legrand**

BTicino (Thailand) Limited reserves the right to change specifications, designs and prices without notice. All illustrations and descriptions are for pure guidance. บริษัทฯ ขอสงวนสิทธิ์ ในการเปลี่ยนแปลงรายละเอียด การออกแบบ และราคาของสินค้า โดยไม่ต้องแจ้งให้ทราบล่วงหน้า - ราคาสินค้ายังไม่รวมภาษีมูลค่าเพิ่ม

